

PC board drilling dimensions (after plating)  
(thickness ≤ 3.20 ± 0.30mm)

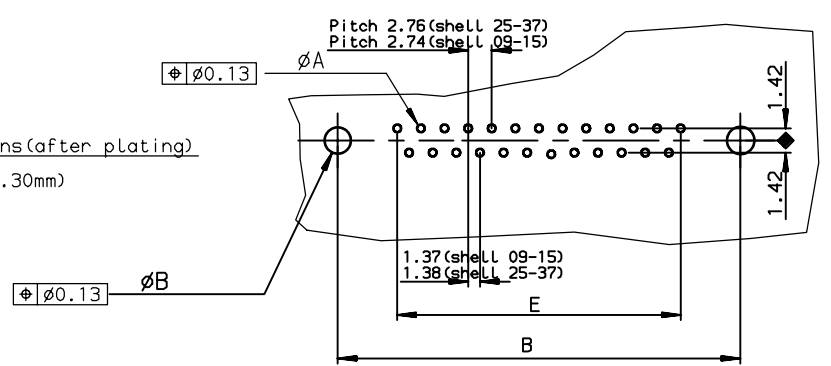

TIN LEAD PART NUMBER

SHELL	A±0.38	B±0.12	C±0.10	D±0.25	E±0.07	PART NUMBER	PART NUMBER
09	30.81	24.99	16.96	16.21	10.96	D09S91C4PA00	D09S91C6PA00
15	39.14	33.32	25.18	24.54	19.18	D15S91C4PA00	D15S91C6PA00
25	53.03	47.04	39.12	38.25	33.12	D25S91C4PA00	D25S91C6PA00
37	69.32	63.50	55.68	54.71	49.68	D37S91C4PA00	D37S91C6PA00
						gold flash	0.76µ gold

SHELL	A±0.38	B±0.12	C±0.10	D±0.25	E±0.07	PART NUMBER	PART NUMBER
09	30.81	24.99	16.96	16.21	10.96	D09S91C4PA00LF	D09S91C6PA00LF
15	39.14	33.32	25.18	24.54	19.18	D15S91C4PA00LF	D15S91C6PA00LF
25	53.03	47.04	39.12	38.25	33.12	D25S91C4PA00LF	D25S91C6PA00LF
37	69.32	63.50	55.68	54.71	49.68	D37S91C4PA00LF	D37S91C6PA00LF
						gold flash	0.76µ gold

GENERAL CHARACTERISTICS AND ROHS INFORMATIONS:  
SEE DRAWING C01-8646-0001

European Views

www.fciconnect.com		surface ISO 1302 ✓	tolerance std ISO 406 ISO 1101	projection mm	size A3		Scale 2
TOLERANCES UNLESS OTHERWISE SPECIFIED				ANGULAR		LINEAR	
Dr JOUBERT 1995/08/11		0.X ±0.1		size		ECN LS06-0140	
Eng PESSON 1995/08/11		0.XX ±0.1		size		Scale 2	
Chr LEGARE 1995/08/11		0.XXX ±0.1		ECN		LS06-0140	
Appr LEGARE 1995/08/11		Product family		D-SUB		Spec ref -	
FCI		FEMALE CONNECTOR DELTA D STD EUROPE		dwg no		C01-8646-0127	
title		straight press-fit		CUSTOMER		sheet 1 of 1	
catalog no							

rev	ecn no	dr	date
F	-	-	1996/07/17
G	LS05-004	MPE	2005/02/07
H	LS06-0095	LGO	2006/06/19
J	LS06-0140	LGO	2006/09/22
-	-	-	-
-	-	-	-
-	-	-	-

Copyright FCI