

MATERIAL NUMBER	PIN CONFIGURATION	QUANTITY PER PACK
848649002	STRAIGHT	35
848649003	90 DEGREE	35

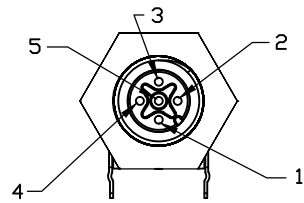

FACE VIEW
(STRAIGHT)

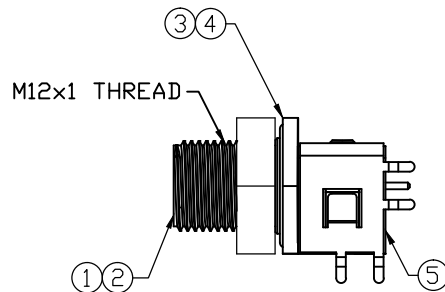

STRAIGHT PIN CONFIGURATION

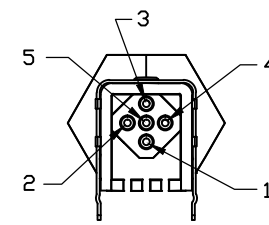

BACK VIEW
(STRAIGHT)

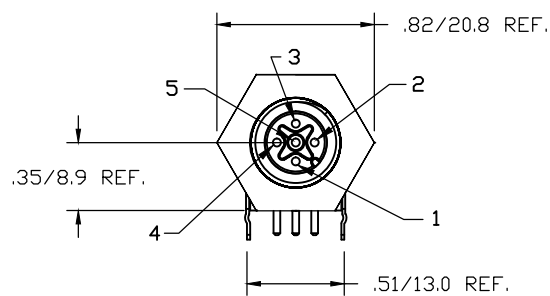
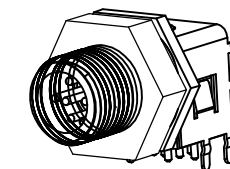

FACE VIEW
(90° CONFIG.)

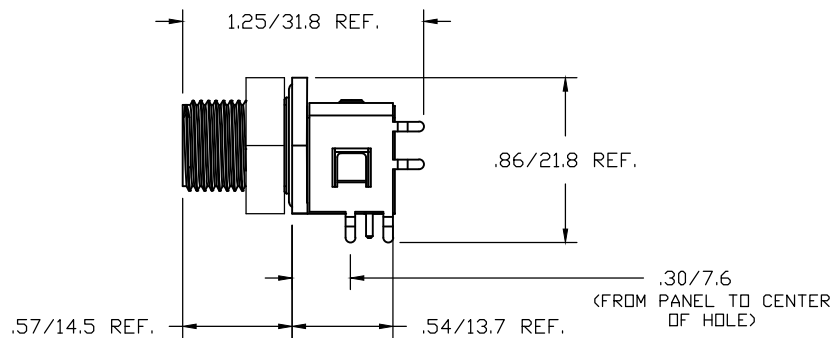

90° PIN CONFIGURATION

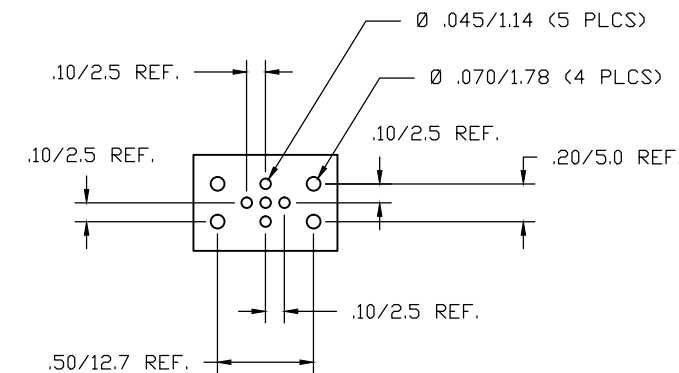

RECOMMENDED PCB LAYOUT
(BOTH STRAIGHT & 90°)

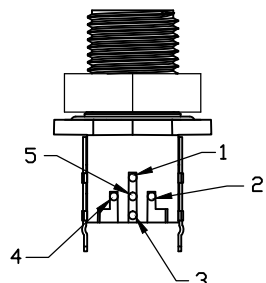

BOTTOM VIEW
(90° CONFIG.)

NOTE:
PANEL THICKNESS - .14 MAX.

VOLTAGE RATING	250 VAC/VDC
AMPERAGE RATING	4 AMPS
PROTECTION	IP67
OPERATING TEMPERATURE	-20°C TO 80°C
PANEL HOLE CUT SIZE	Ø .51/12.9

ITEM	COMPONENT	MATERIAL	FINISH
1	INSERT	NYLON	BLACK
2	CONTACT PIN	COPPER ALLOY	GOLD OVER NICKEL
3	RECEPTACLE SHELL	DELTRIN	BLACK
4	O-RING	VITON	
5	BRACKET	STEEL	TIN PLATED

UPDATED DIM & VIEWS EC NO: IPG2015-1651 DRWN: BARDEN 2015/03/18 CHKD: --- APPR: BWOODMAN 2011/08/13	DESCRIPTION REV	QUALITY SYMBOLS	GENERAL TOLERANCES (UNLESS SPECIFIED)		DIMENSION STYLE		SCALE	DESIGN UNITS	THIRD ANGLE PROJECTION M12 PCB MOUNT MALE 5 POLE RECEPTACLE MOLEX INCORPORATED SD-84864-003 SHEET NO. 1 OF 1
		$\nabla=0$ $\sphericalangle=0$	mm	INCH	IN/MM	1:1	INCH		
		4 PLACES ±-- ±-- 3 PLACES ±-- ±.005 2 PLACES ±-- ±.01 1 PLACE ±0.3 ±.02	ANGULAR ±1/2°		DRAWN BY DATE BW 2009/08/26 CHECKED BY DATE JMACNEIL 2007/10/10 APPROVED BY DATE JFMURPHY 2011/08/13	TITLE			
		DRAFT WHERE APPLICABLE MUST REMAIN WITHIN DIMENSIONS		MATERIAL NO. SEE CHART SIZE B	THIS DRAWING CONTAINS INFORMATION THAT IS PROPRIETARY TO MOLEX INCORPORATED AND SHOULD NOT BE USED WITHOUT WRITTEN PERMISSION				