

## DETAILS

<b>Product Number</b>	CA12429_TINA3-OO
<b>Family</b>	Tina3
<b>Type</b>	Assembly
<b>Color</b>	white
<b>Diameter</b>	16,1 mm
<b>Height</b>	6,9 mm
<b>Style</b>	round
<b>Optic Material</b>	PMMA
<b>Holder Material</b>	PC
<b>Fastening</b>	pin, tape
<b>Status</b>	ready
<b>ROHS Compliant</b>	Yes
<b>Date Updated</b>	12/11/2013



## OPTICAL PROPERTIES

LED	Viewing	Light	Effi-		Connector
	Angle	Beam	ciency	cd/lm	
LUXEON H50-2	sim: 37+57	OO-class	sim: 87 %	sim: 1.300	-
LH351Z	47+62 deg	OO-class	88 %	1.100	-
XP-G	51+35 deg	OO-class	90 %	1.400	-
Oslon Square EC	55+39 deg	OO-class	88 %	1.100	-
LUXEON A	57+29 deg	OO-class	90 %	1.200	-
LUXEON T	58+40 deg	OO-class	88 %	1.200	-
LUXEON TX	59+42 deg	OO-class	88 %	1.200	-
NVSxx19A	61+45 deg	OO-class	87 %	1.000	-

D

C

B

A

4

4

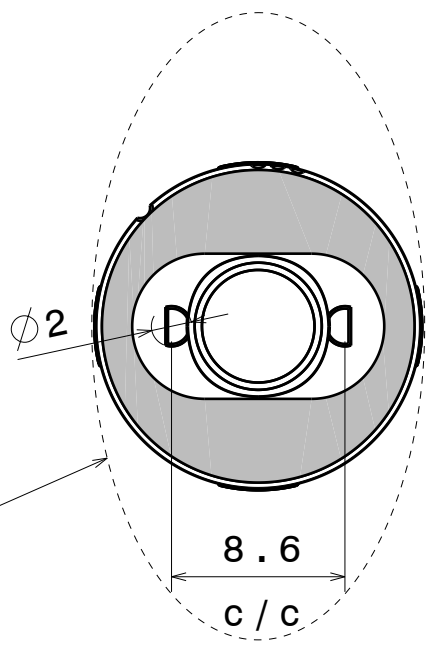
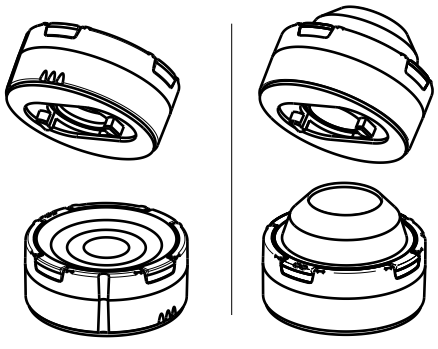

Oval beam direction

8.6

c / c

3

3

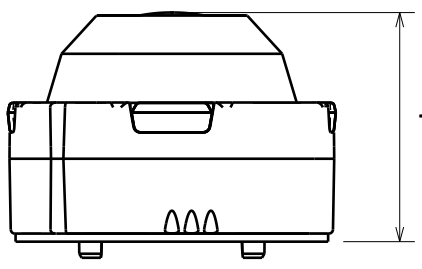

11.4

Spot version height

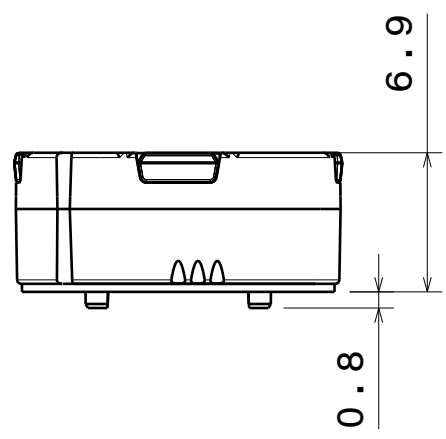

6.9

0.8

2

2

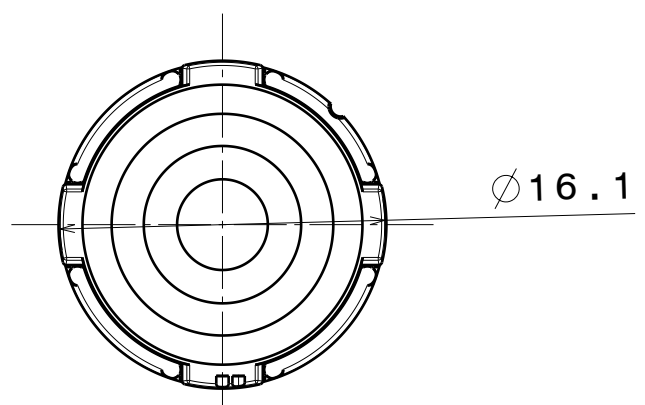

Ø 16.1

Top view

Tolerances if not otherwise shown  
 According to DIN ISO 2768-1  
 Linear measures:  
 Up to 30mm class M, otherwise class C.  
 According to DIN ISO 2768-2  
 Form and position: class L

**LEDiL** LediL Oy  
 Salorankatu 10  
 FIN 24240 SALO  
 Finland

THIRD ANGLE PROJECTION:

DRAWING TITLE  
**TINA3 Datasheet**

This drawing is the property of LEDiL Oy. It may not be reproduced, copied or communicated without a written agreement with LEDiL Oy."

SIZE PART NUMBER  
**A4 -**

SCALE 4:3 WEIGHT - SHEET 1/1

D

A

1

Luminaire: Ledil Oy CA12429\_TINA3-OO\_(LH351Z) Efficiency=88%  
Lamps: 1 x Samsung LH351Z (90.14lm @ 250mA) CCT=6500K P=0.7W I=250mA

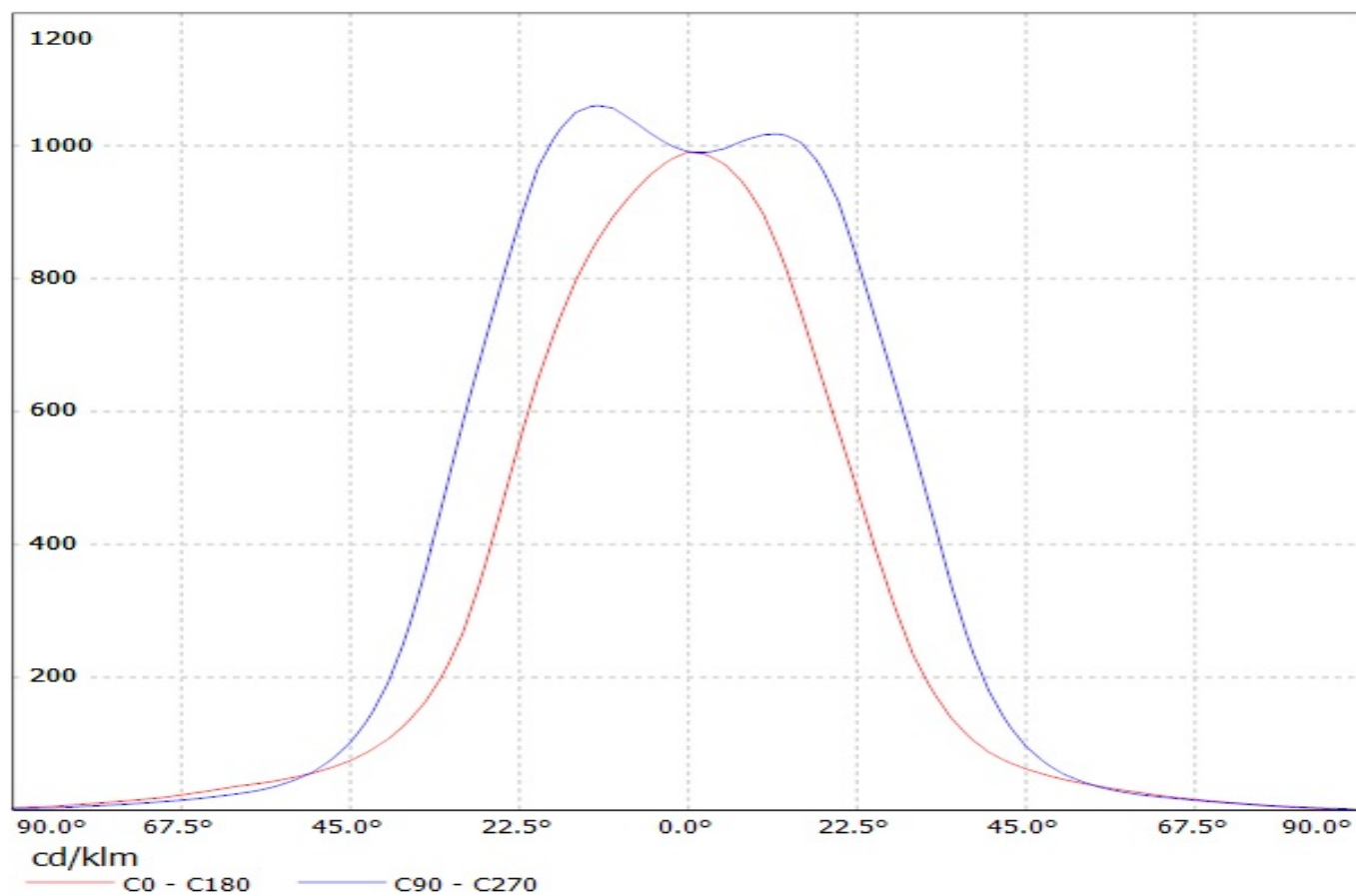

Luminaire: Ledil Oy CA12429\_TINA3-00 (Cree XP-G 68lm @ 250mA) Efficiency=90%  
Lamps: 1 x Cree XP-G 68lm @ 250mA

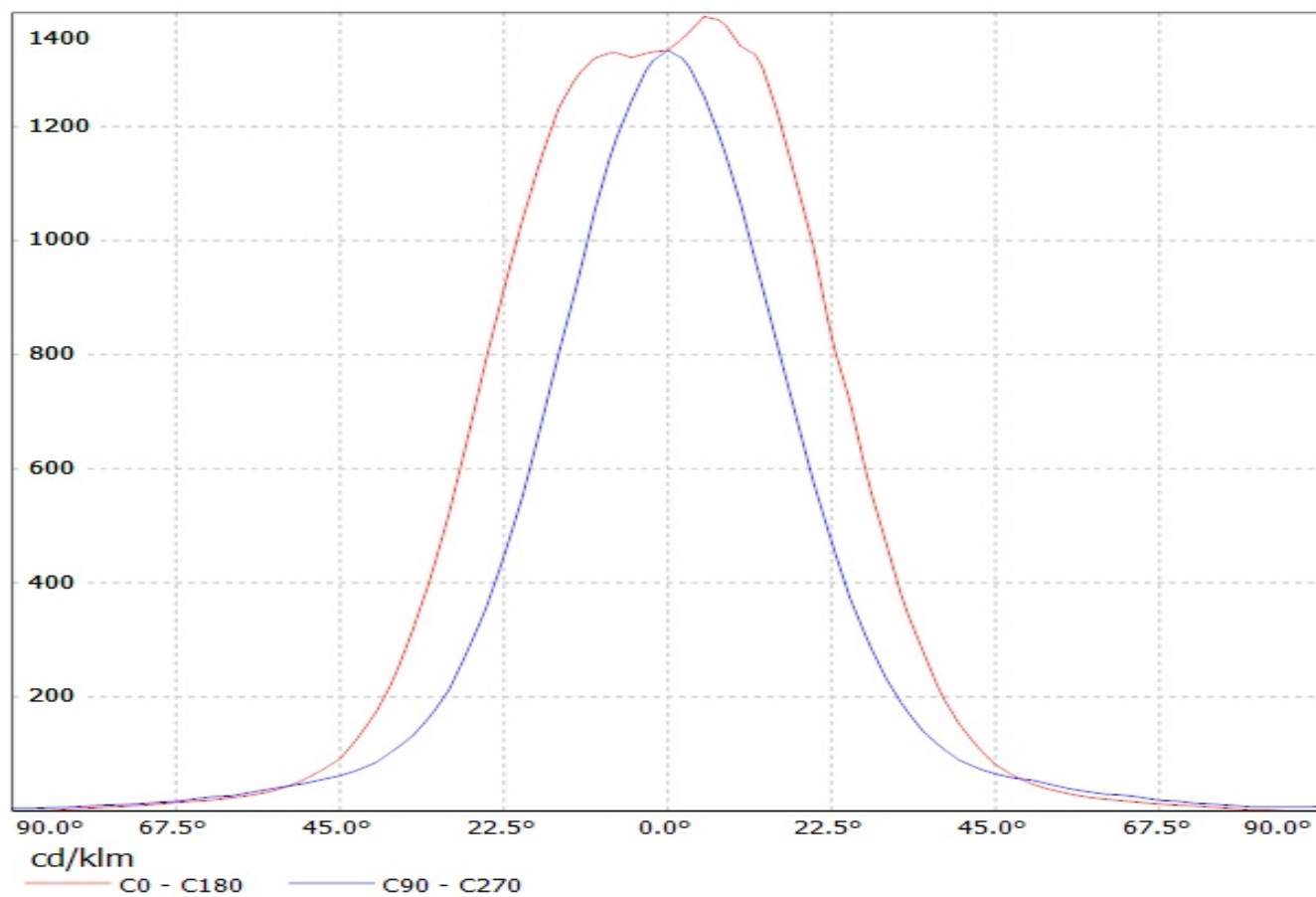

Luminaire: Ledil Oy CA12429\_TINA3-00 (Osram Square EC 66lm @ 250mA) Efficiency=88%  
Lamps: 1 x Osram Square EC 66lm @ 250mA

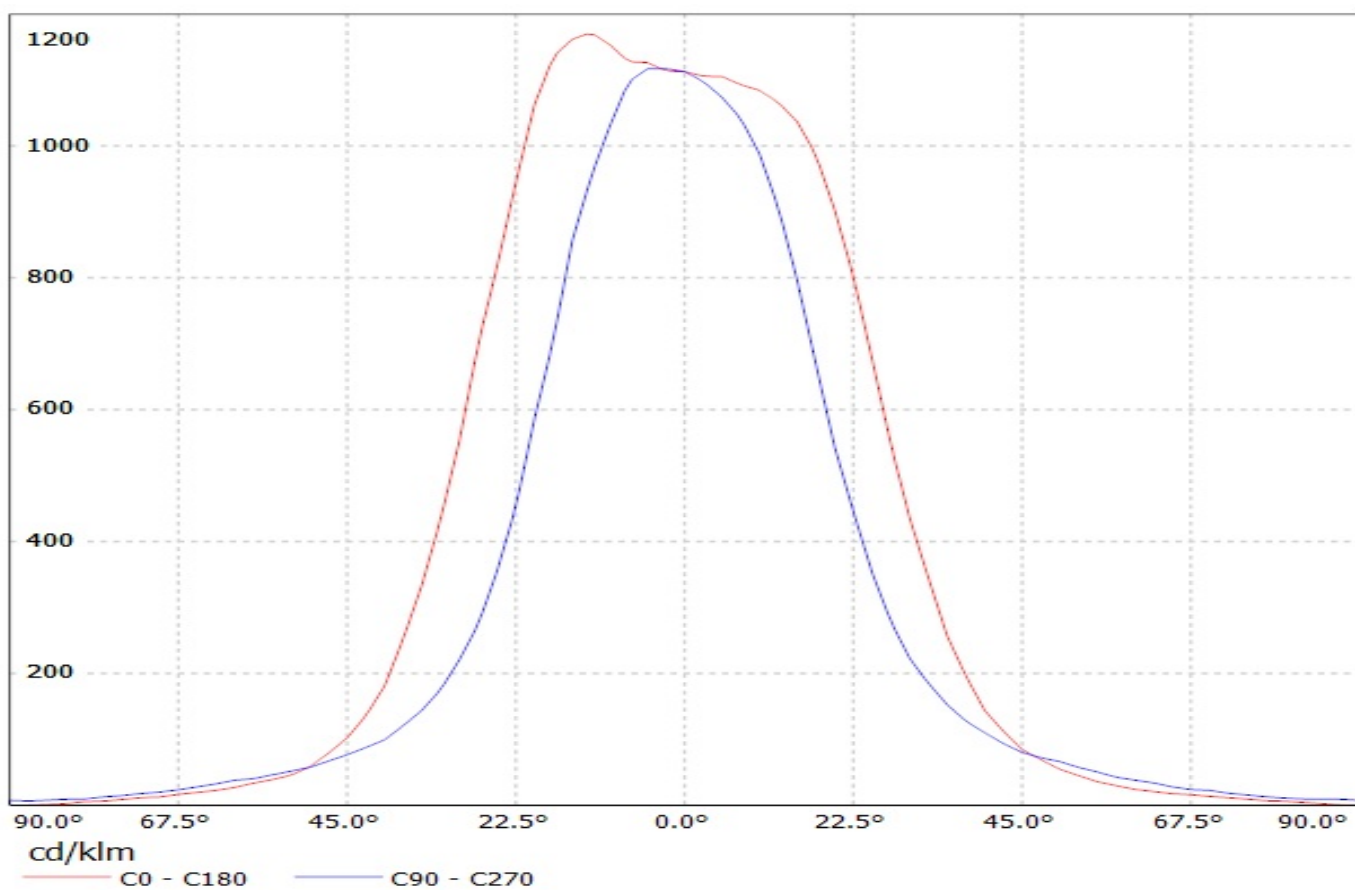

Luminaire: Ledil Oy CA12429\_TINA3-00 (Luxeon A 64lm @ 250mA) Efficiency=90%  
Lamps: 1 x Luxeon A 64lm @ 250mA

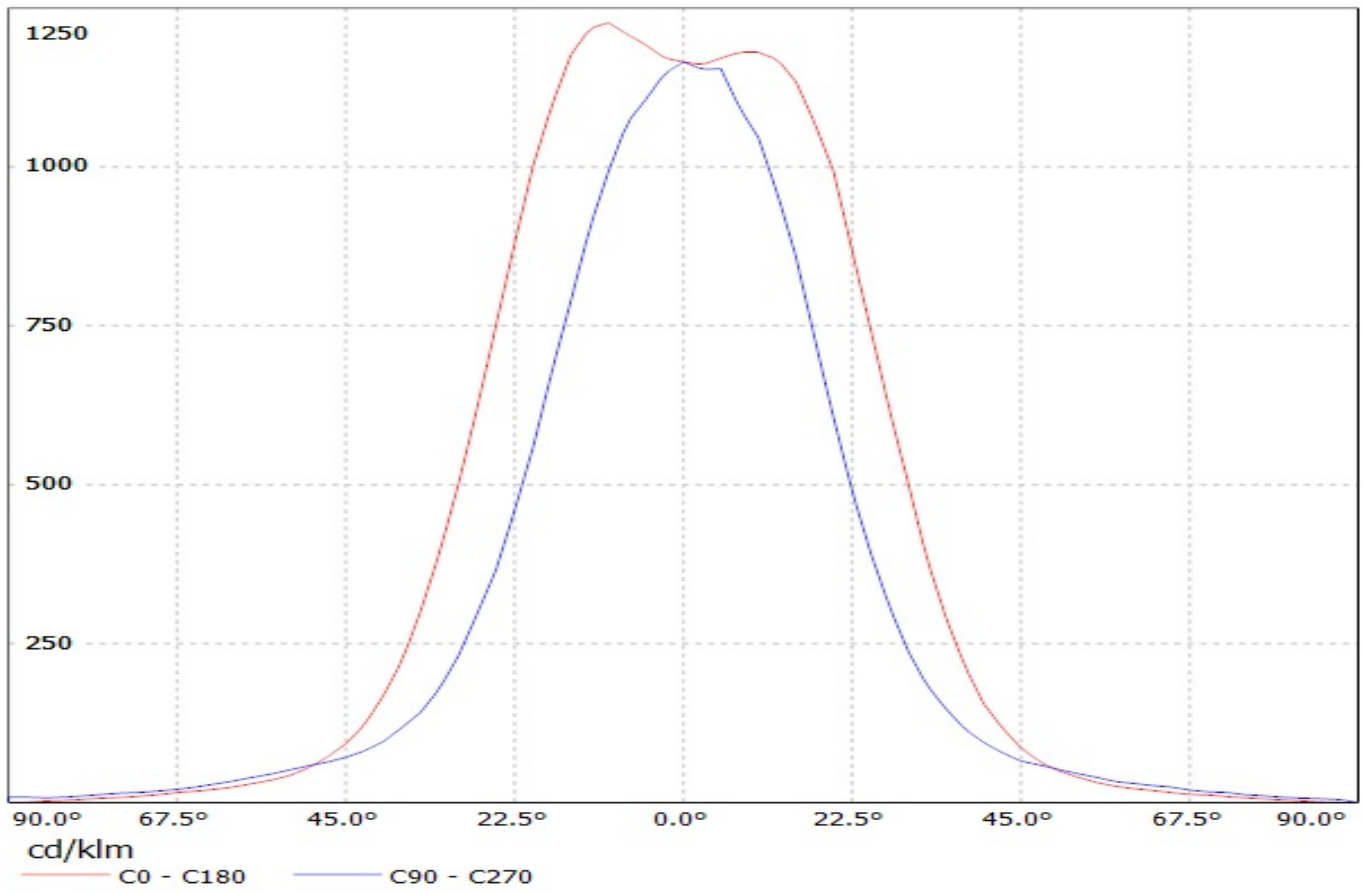

Luminaire: LEDiL Oy CA12429\_TINA3-00\_(LUXEON\_T) Eff.88.0%  
Lamps: 1 x LUXEON T (74lm@250mA)

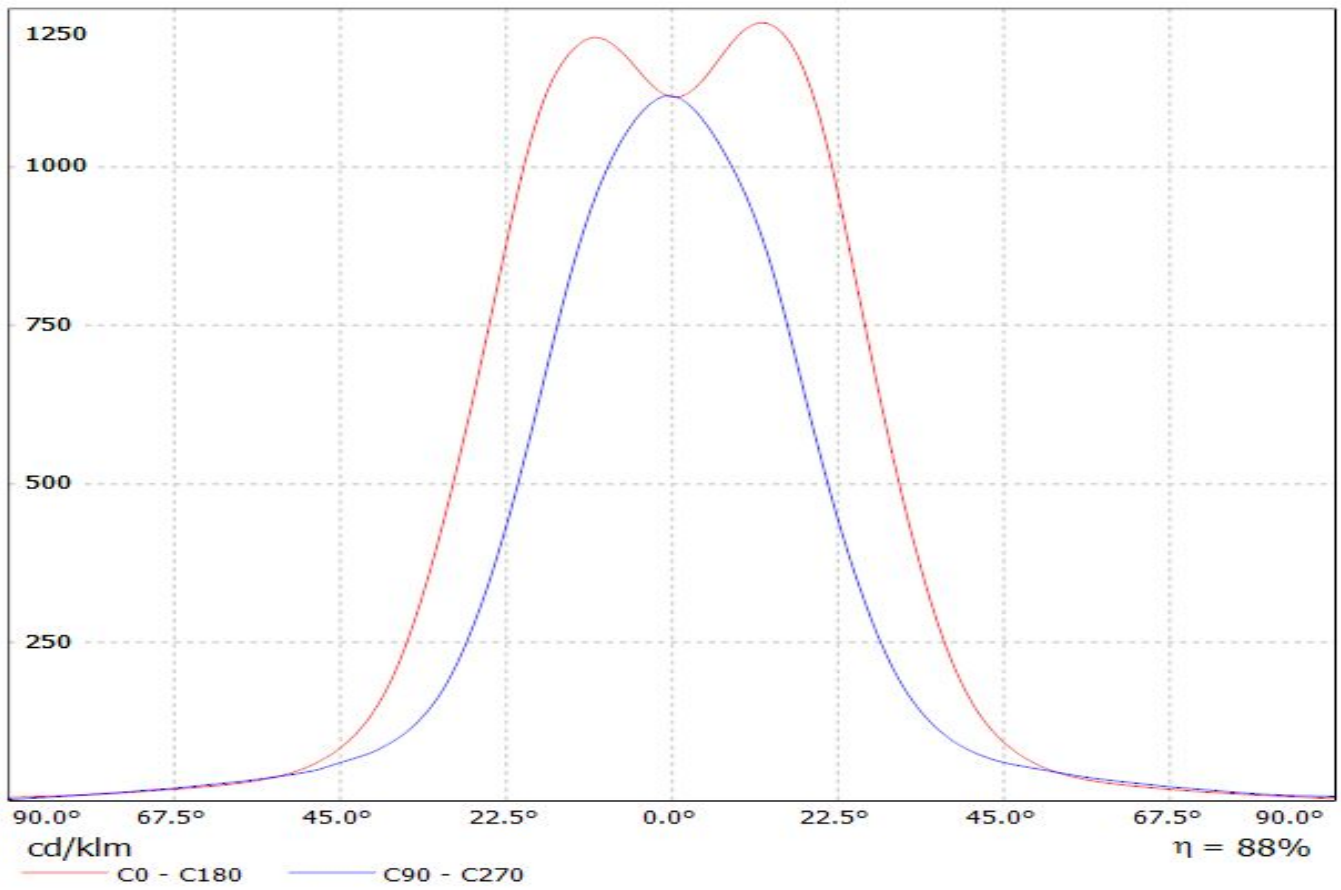

Luminaire: Ledil Oy CA12429\_TINA3-OO\_(Luxeon\_TX) Efficiency=88%  
Lamps: 1 x Luxeon TX (L1T2-3585) 82lm @ 250mA CCT= P=0.73W I=250mA

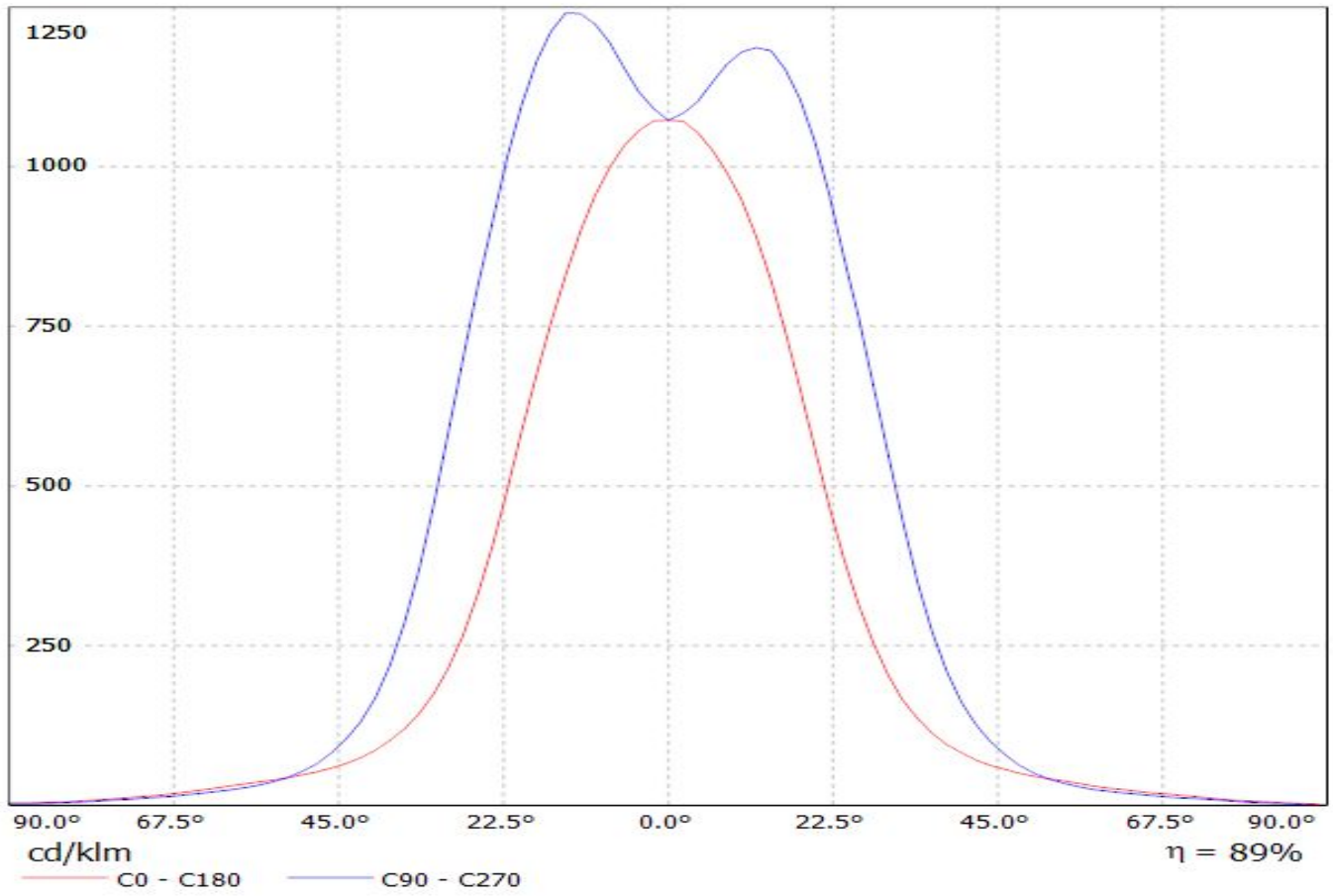



Luminaire: Ledil Oy CA12429\_TINA3-00 (Nichia NVS19 92lm @ 250mA) Efficiency=87%  
Lamps: 1 x Nichia NVS19 92lm @ 250mA

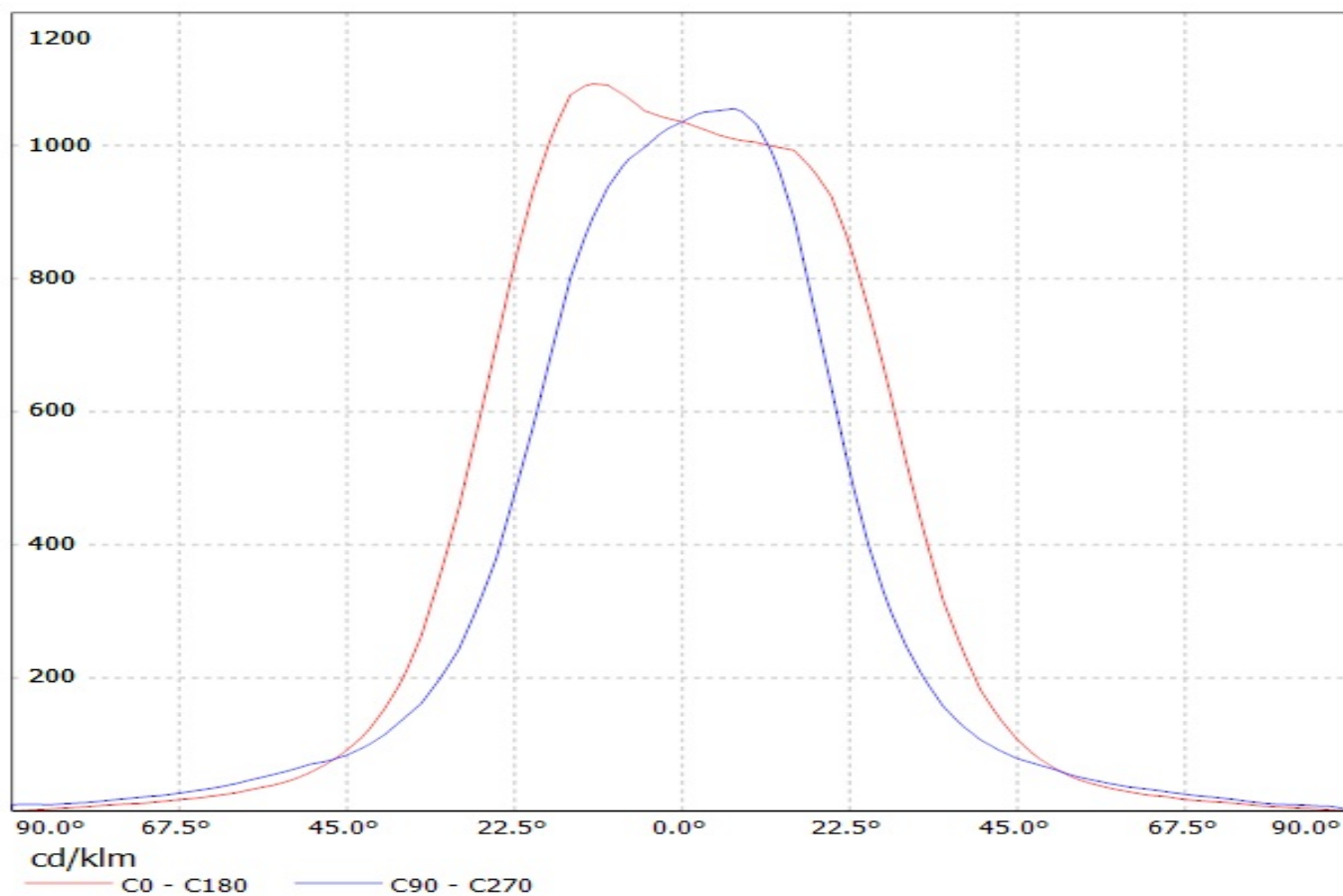

Luminaire: Ledil Oy CA12429\_TINA3-OO\_(LH351Z) Efficiency=88%  
Lamps: 1 x Samsung LH351Z (90.14lm @ 250mA) CCT=6500K P=0.7W I=250mA

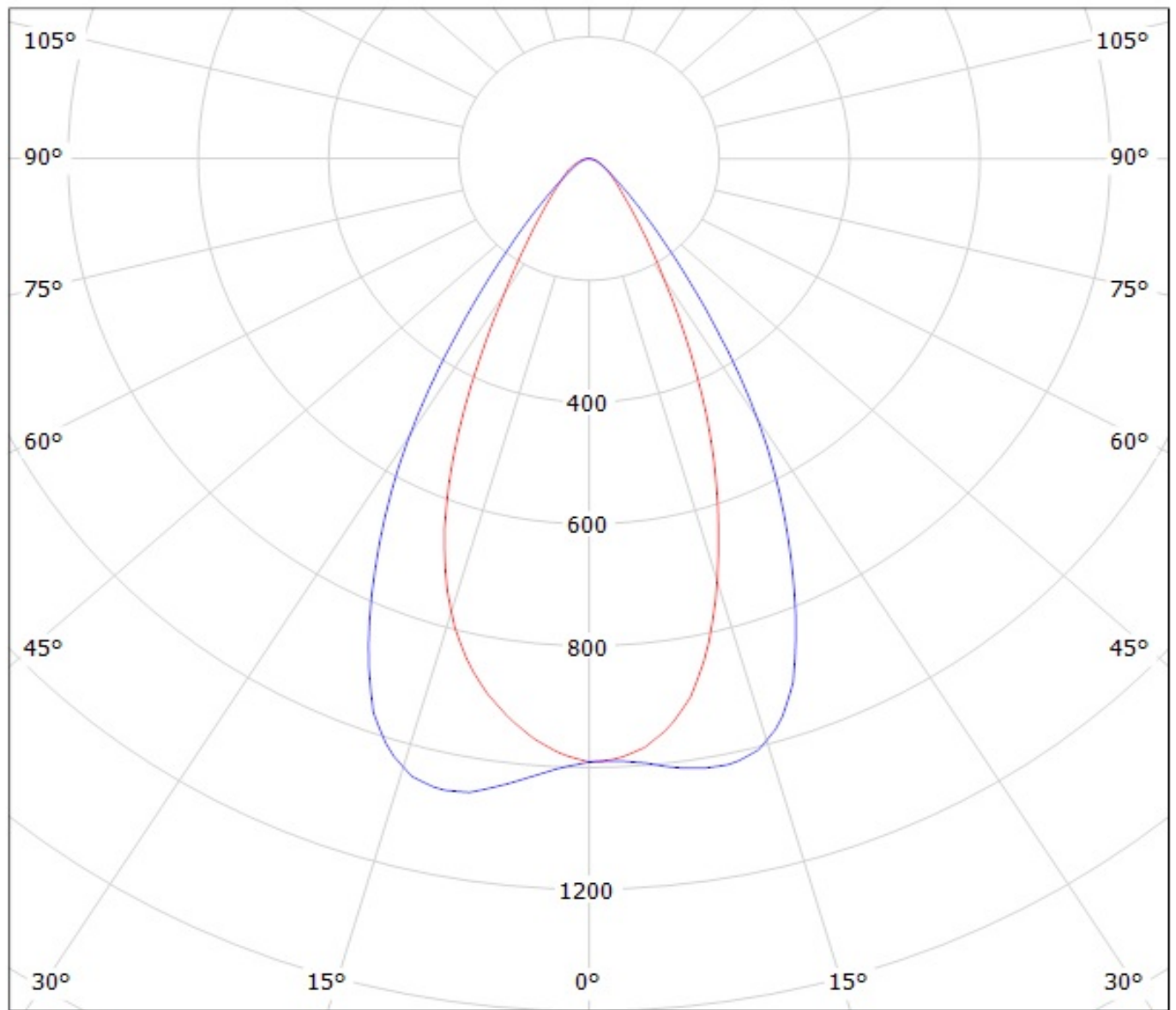

cd/klm

— C0 - C180

— C90 - C270

Luminaire: Ledil Oy CA12429\_TINA3-00 (Cree XP-G 68lm @ 250mA) Efficiency=90%  
Lamps: 1 x Cree XP-G 68lm @ 250mA

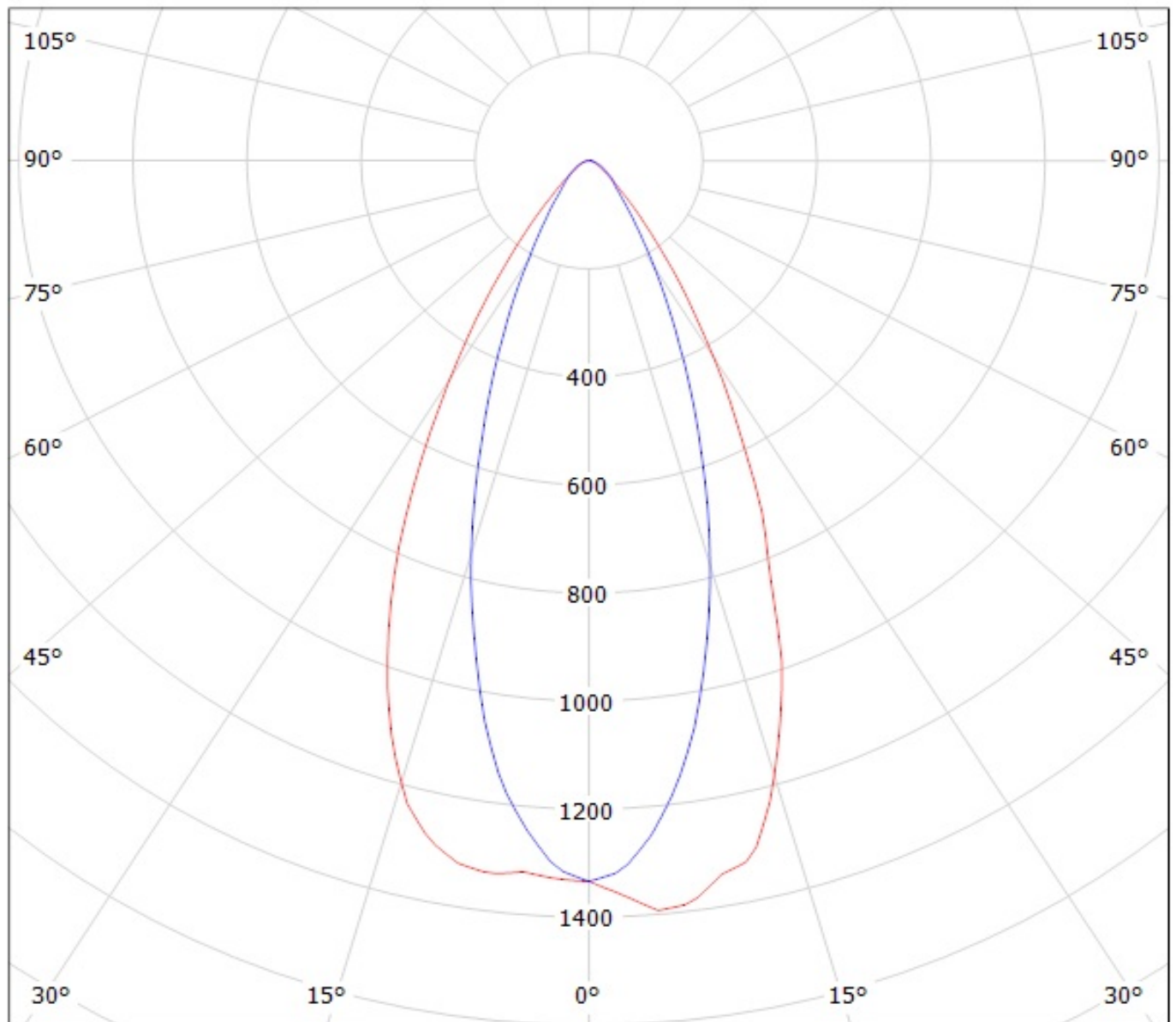

cd/klm

— C0 - C180    — C90 - C270

Luminaire: Ledil Oy CA12429\_TINA3-00 (Osram Square EC 66lm @ 250mA) Efficiency=88%  
Lamps: 1 x Osram Square EC 66lm @ 250mA

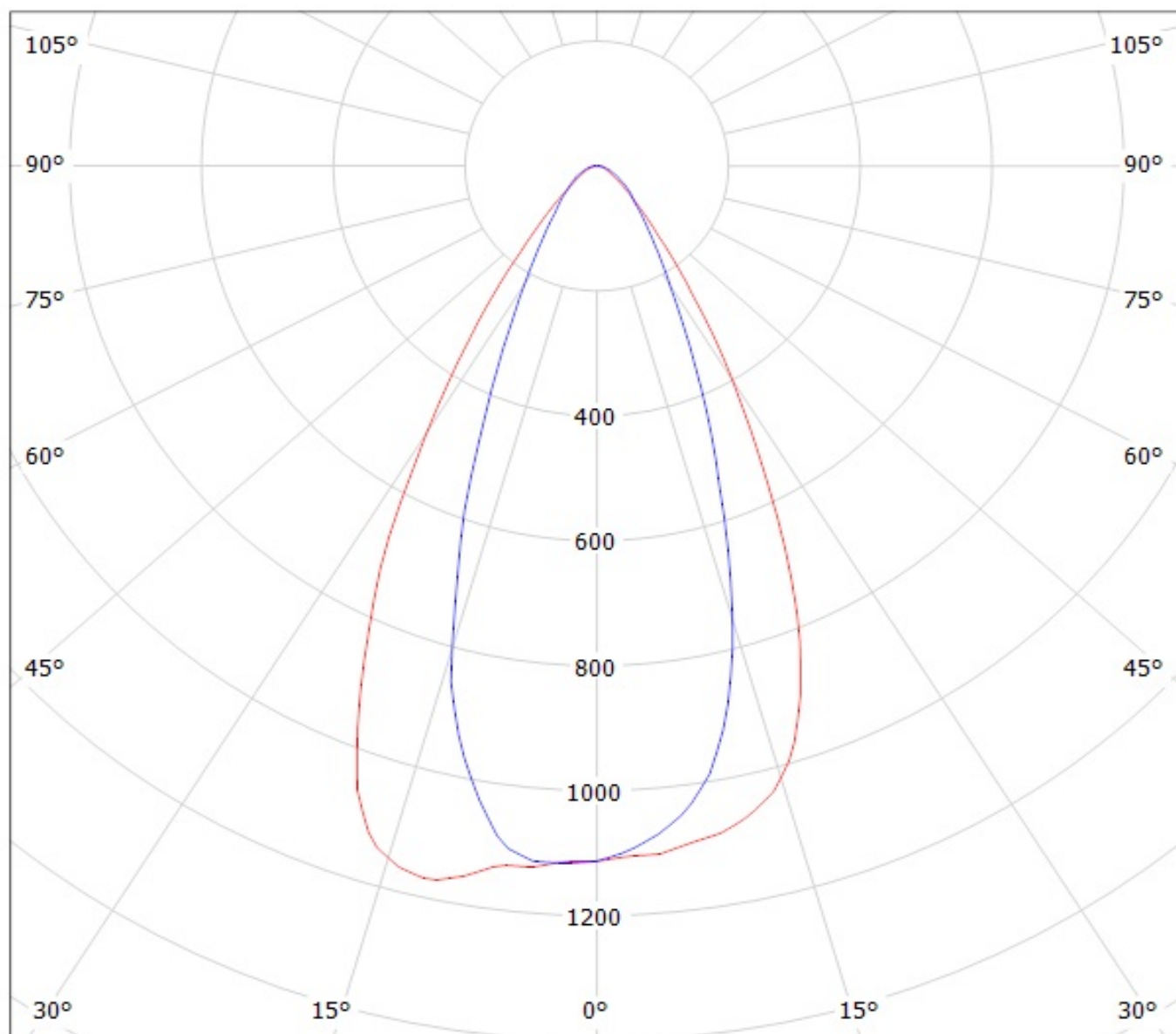

cd/klm

— C0 - C180

— C90 - C270

Luminaire: Ledil Oy CA12429\_TINA3-OO (Luxeon A 64lm @ 250mA) Efficiency=90%  
Lamps: 1 x Luxeon A 64lm @ 250mA

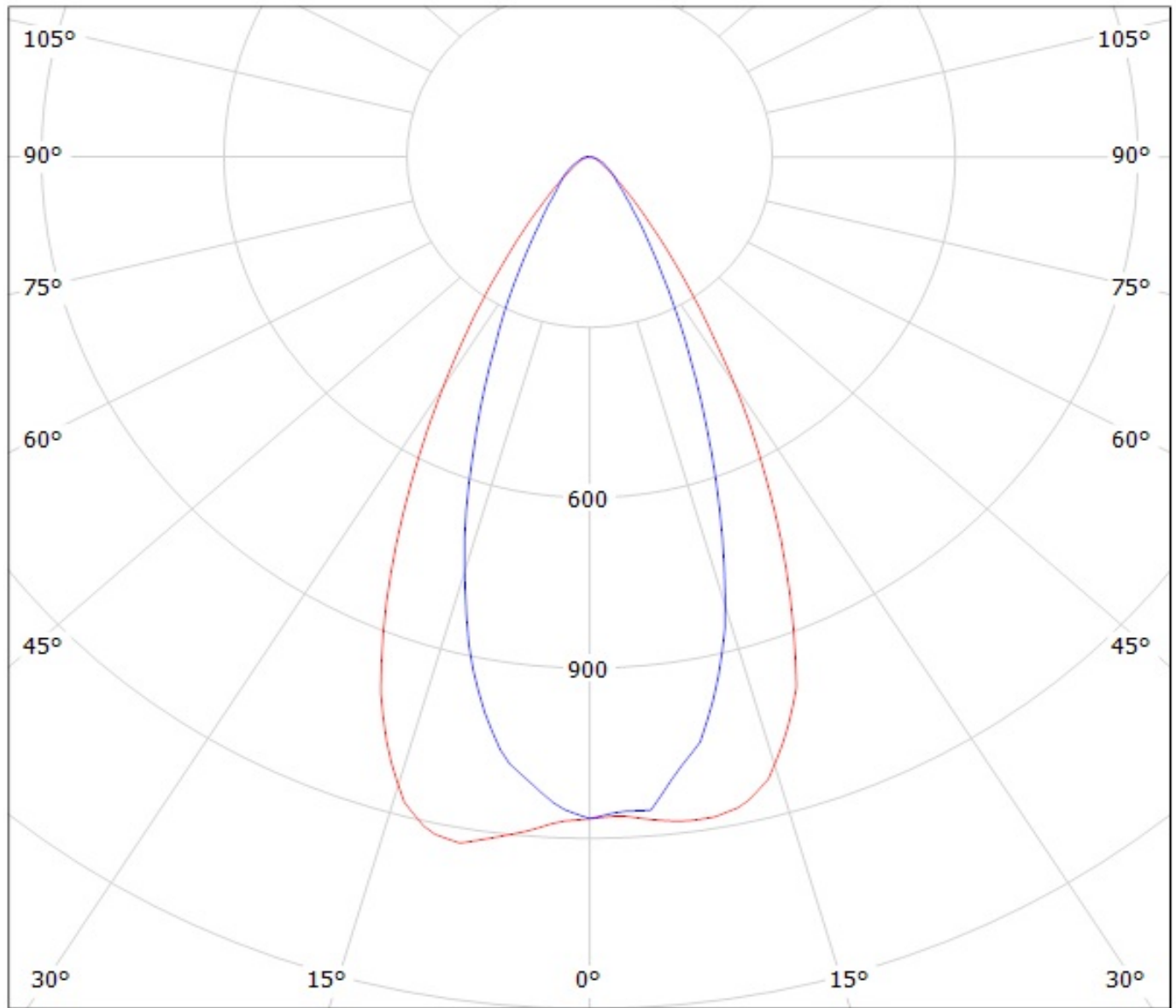

cd/klm

— C0 - C180

— C90 - C270

Luminaire: LEDiL Oy CA12429\_TINA3-00\_(LUXEON\_T) Eff.88.0%  
Lamps: 1 x LUXEON T (74lm@250mA)

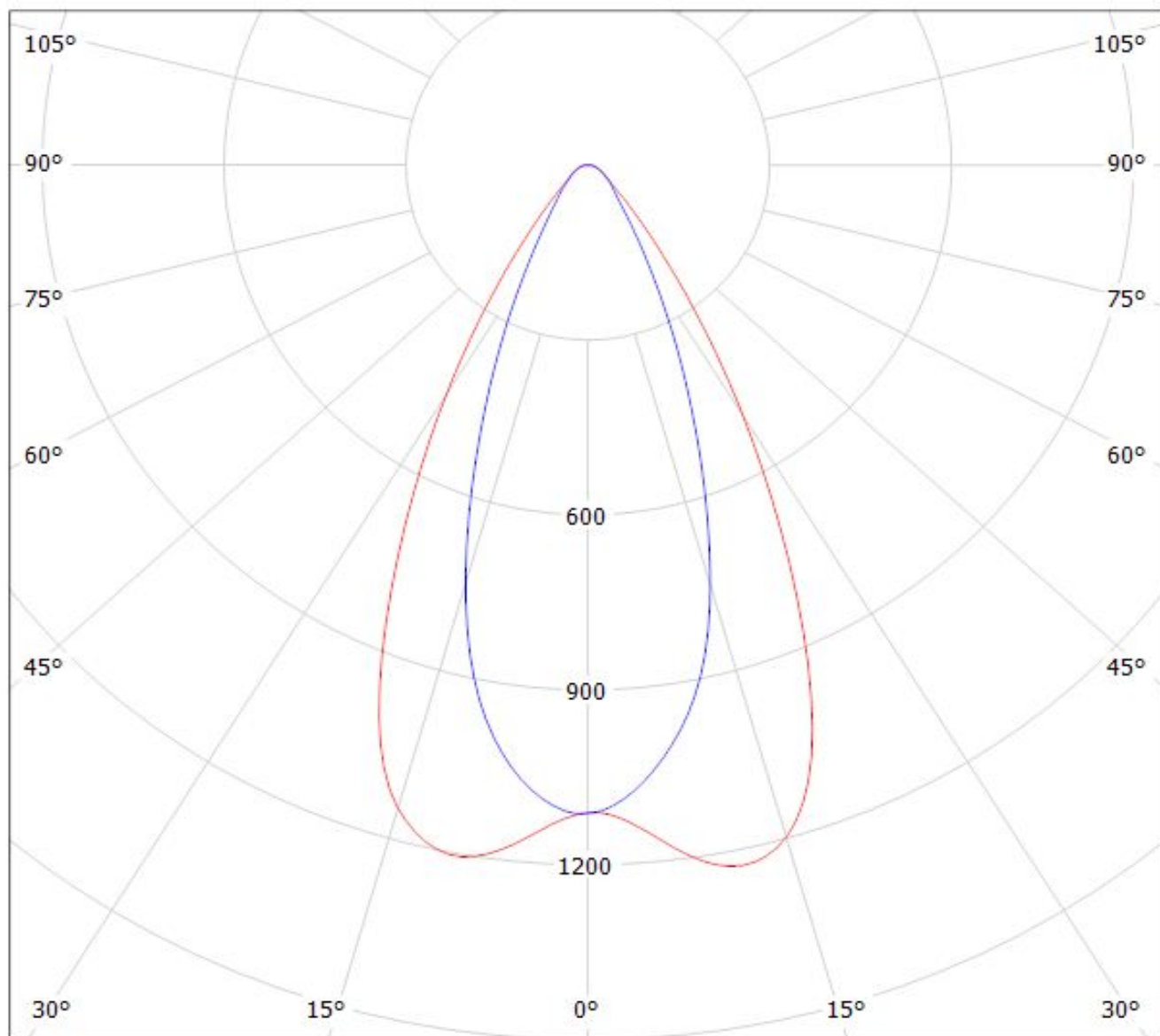

cd/klm

— C0 - C180    — C90 - C270

$\eta = 88\%$

Luminaire: Ledil Oy CA12429\_TINA3-OO\_(Luxeon\_TX) Efficiency=88%  
Lamps: 1 x Luxeon TX (L1T2-3585) 82lm @ 250mA CCT= P=0.73W I=250mA

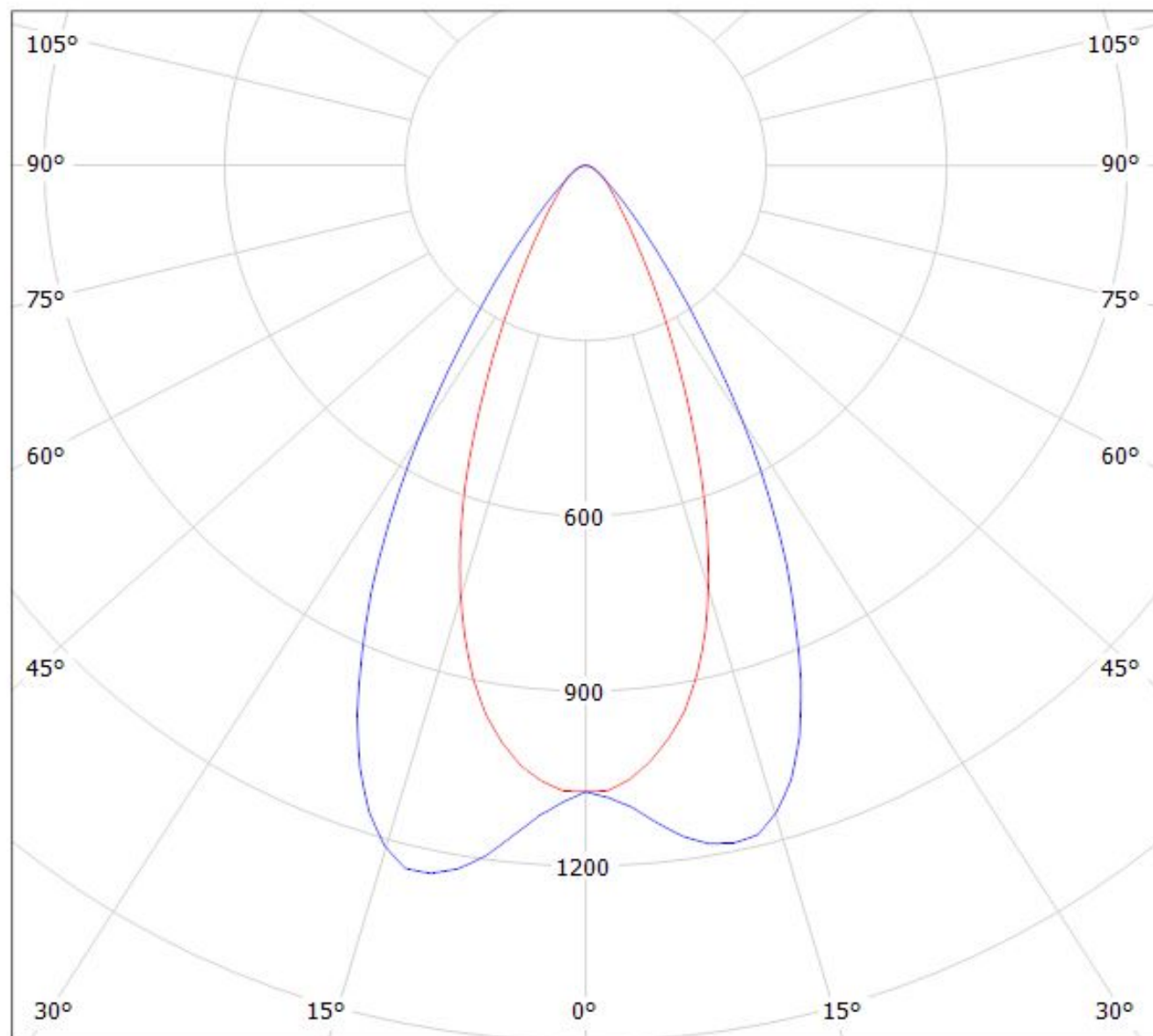

cd/klm

— C0 - C180    — C90 - C270

$\eta = 89\%$

Luminaire: Ledil Oy CA12429\_TINA3-00 (Nichia NVS19 92lm @ 250mA) Efficiency=87%  
Lamps: 1 x Nichia NVS19 92lm @ 250mA

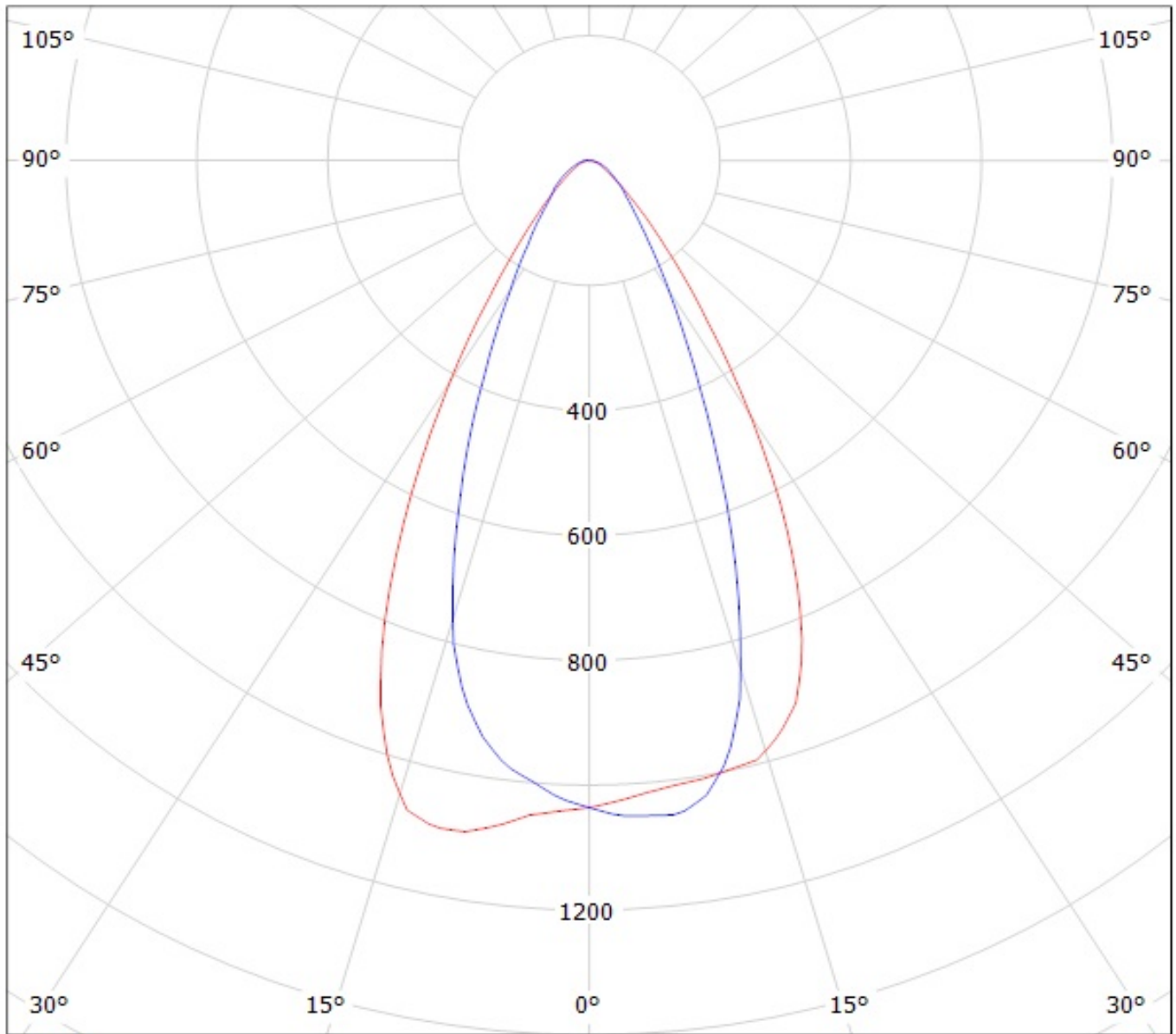

cd/klm

— C0 - C180 — C90 - C270



**NOTE: The typical divergence will be changed by different color, chip size and chip position tolerance. The typical total divergence is the full angle measured where the luminous intensity is half of the peak value.**