

STRIP LENGTH: 16mm

- NOTES:
1. ROHS COMPLIANT
 2. -40°C TO 85°C OPERATING TEMPERATURE
 3. SUITABLE FOR POF WITH $\phi 2.2\text{mm}$ BUFFER AND $\phi 1.0\text{mm}$ OPTICAL CORE
 4. TIA 604.1 (FOCUS 1)
 5. MAXIMUM TORQUE: 8in-lbs

INSTRUCTIONS:

1. STRIP A 16mm LENGTH OF JACKET OFF OF FIBER.
2. SLIP BOOT OVER CABLE.
3. APPLY EPOXY TO INSIDE OF SMA CONNECTOR AND BARE FIBER.
4. INSERT BARE FIBER INTO SMA CONNECTOR; ROTATE FIBER DURING INSERTION TO EVENLY DISTRIBUTE EPOXY.
5. CRIMP CONNECTOR TO CABLE ABOVE RETENTION RIDGES AND SLIP BOOT OVER CONNECTOR BODY TO FINISH INSTALLATION. ALLOW EPOXY TO CURE BEFORE POLISHING.



METRIC

REV	DESCRIPTION	ECO	DATE	DWN	APVD
B	ADDED BOOT INFORMATION	0036	09/29/09	BB	KS

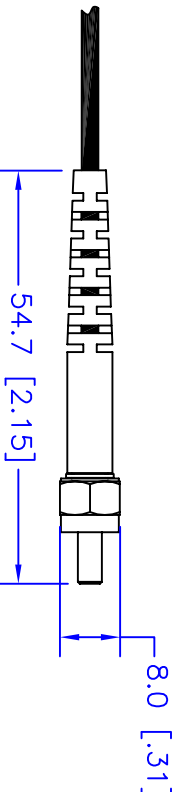
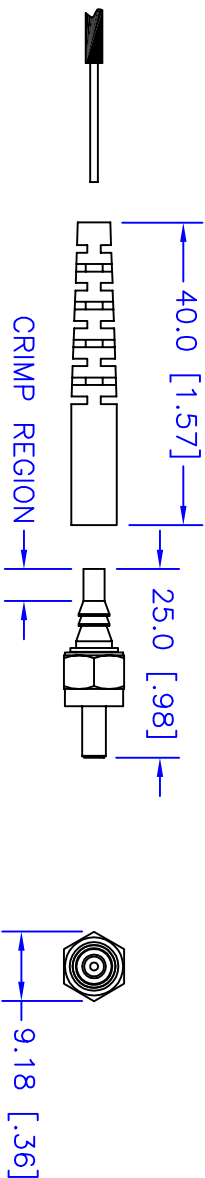
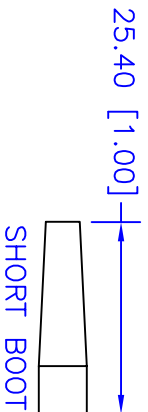

RECOMMENDED EPOXY:
EPO-TEK 301

CRIMP TOOL: IF 370046
USE 2.5 [.10] HEX CRIMP

UNLESS OTHERWISE SPECIFIED
DIMENSIONS MILLIMETERS [IN.]

TOLERANCES	SURFACE
0 PLC: ± 1	3.2/
1 PLC: $\pm .25$	TEXTURE: \checkmark
2 PLC: $\pm .127$	
3 PLC: $\pm .025$	
4 PLC: $\pm .013$	
ANGLE: $\pm 1/2^\circ$	

REMOVE BURRS AND SHARP EDGES
FLATNESS .005 MM PER MM
ALL DIMENSIONS AFTER FINISH

51 0053	W/STANDARD BLACK BOOT
51 0054	W/STANDARD RED BOOT
51 0056	W/STANDARD BLUE BOOT
51 0057	W/STANDARD YELLOW BOOT
51 0058	W/STANDARD WHITE BOOT
51 0062	W/SHORT BLACK BOOT

INDUSTRIAL FIBER OPTICS
TEMPE, AZ 85281

NAME
SMA WITH BOOT

PRODUCT	MATERIAL
303 STAINLESS	303 STAINLESS
FINISH	NONE
DRAWN BY	BIDWELL
DATE	06/22/09
CHECKED BY	STOTIZ
DATE	09/29/09

SIZE	SCALE	PART NUMBER	REV
A	1:1	51 0053	B

DO NOT SCALE DRAWING	SHEET	OF
	1	1