

| REV. | DATE | DESCRIPTION |
|------|----------|-----------------|
| NC | 07/07/04 | INITIAL RELEASE |

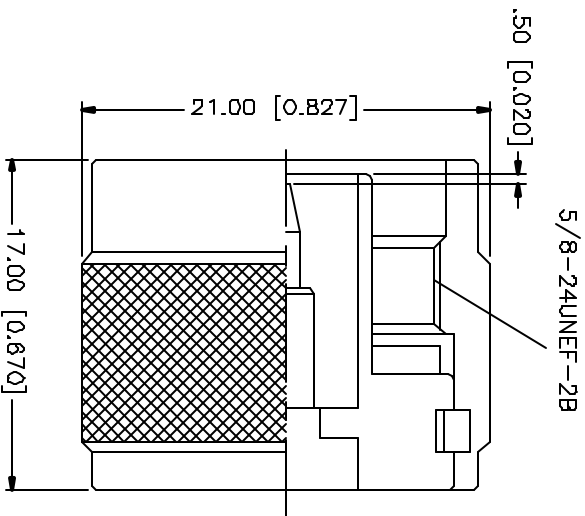

| REV | DESCRIPTION | MATERIAL | FINISH | QTY | UNLESS OTHERWISE SPECIFIED DIMENSIONS ARE IN MILLIMETERS (DIMENSIONS IN [] ARE IN INCHES AND FOR STATUTE MEASUREMENT ONLY). TOLERANCES FOR MILLIMETERS ARE: 0.5 - 8mm ± 0.20mm 8 - 10mm ± 0.40mm 10 - 120mm ± 0.50mm UNLESS OTHERWISE SPECIFIED DIMENSIONS FOR INCHES ARE: .020 - .315 ± 0.0075" .315 - 1.180 ± 0.015" 1.180 - 4.724 ± 0.025" DO NOT SCALE DRAWING | APPROVALS | DATE | PART DESCRIPTION | | | | | | |
|-----|--------------|----------|----------|-----|--|-------------------|----------|---|------|----|------|---|-------|----|
| B | | | | | DRAWN | C.R.S. | 07/07/04 | <p>Amphenol Connex</p> <p>N SHORTING PLUG</p> <p>PART NO. 172317</p> | | | | | | |
| 7 | | | | | CHECKED | | | | | | | | | |
| 6 | | | | | DESIGNED | | | | | | | | | |
| 5 | | | | | SHEET | 1 OF 1 | | | | | | | | |
| 4 | | | | | | | | | | | | | | |
| 3 | CONTACT BODY | BRASS | GOLD | 1 | | | | | | | | | | |
| 2 | BODY | BRASS | NEGGOTIE | 1 | | | | | | | | | | |
| 1 | | | | | | | | | | | | | | |
| | DESCRIPTION | MATERIAL | FINISH | QTY | CDW FILE | C:/172/172317.DWG | DWG. NO. | 172317.DWG | REV. | NC | SIZE | A | SCALE | NA |